

CREEK

TOP OF BANK

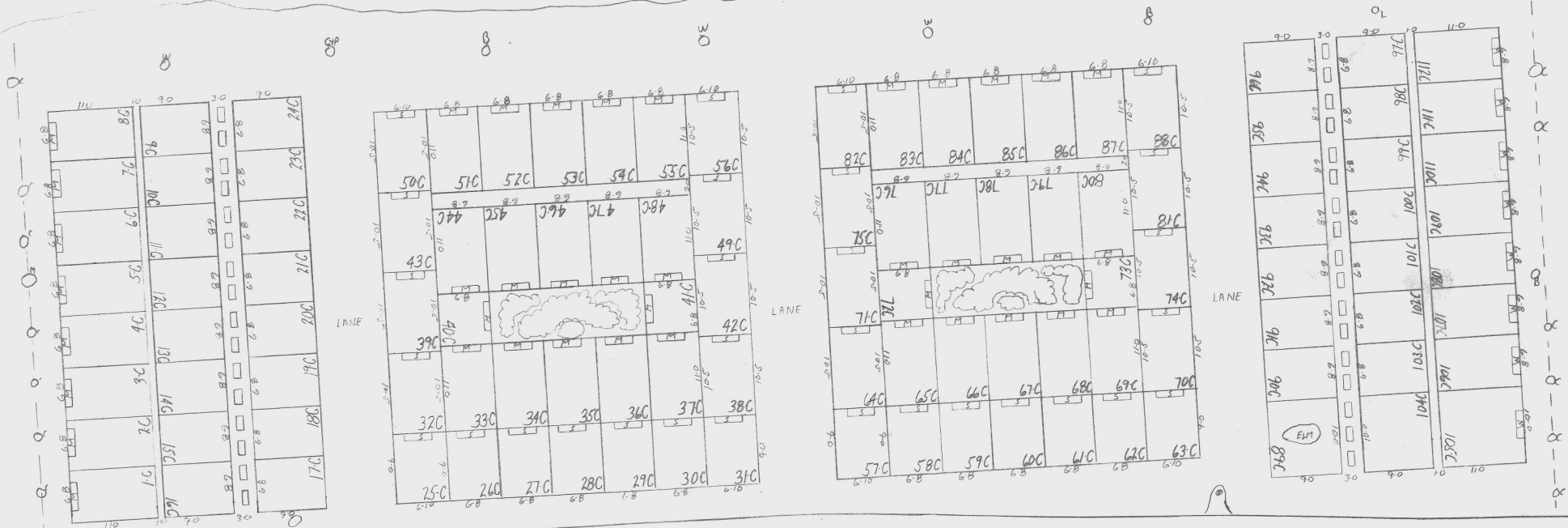

ROAD

- M MONUMENT LOTS
- S SLANT MARKER LOTS

LOT NO. 40, 41, 72, 73 CRETAINS ONLY  
 LOT NO. 9 THRU 24, 89 THRU 104  
 COLONIAL MARKER INSCRIPTION PRIVILEGE

# SECTION 27-C

1"=10'

9-26-87

KWP CER